



# Contents

---

Characteristics of Smart Home System-----	01
Packaging List-----	02
Operating Principle -----	03-04
Categories of Detector Zones -----	03
Operating with Multiple Smart Switch -----	04
Introduction of Panel-----	05-07
Powering on the Panel -----	06
Positioning of Panel -----	07
Use of Accessories -----	08-11
Remote Control-----	08
Door/Window Contact-----	09
PIR motion detector -----	09
Smart Switch-----	11
Accessory Pairing /Removal-----	11-12
Pairing Wireless Accessories -----	11
Pairing Wireless siren (requires separate purchase) -----	12
Removal of Wireless Accessories-----	12
Removal of Wireless Siren (requires separate purchase) -----	12
Installation of Accessories -----	13-14
Installation of Door/Window Contact -----	13
Installation of PIR Motion Detector -----	14
App Setting and Operation -----	15-20
Step 1: Download App-----	15
Step 2: WiFi Network Setting -----	16
Step 3: Registration -----	16
Step 4: App Operation-----	17
APN Settings -----	22
Remote Control by Phone -----	23
Restore Default Settings-----	23
FAQs -----	24-25
Specification -----	26-28
Safety Reminder -----	29
Maintenance and Repair -----	30
Disclaimer -----	31

## Gentle Reminder:

Please read the manual thoroughly before use.

Please keep this manual for further reference.

Please ensure proper usage based on a full understanding of this manual.

## Characteristics of Smart Home System

### 1. Stable Transmission

Stable transmission at 315MHz or 433MHz direction frequency and at 868 MHz or 915 MHz bidirectional frequency

### 2. Powerful Functions

Security system and home automation 2 in 1

Supports WiFi and SIM card

Supports 5 alarm notification numbers

Supports 70 wireless accessories (10 remote controls, 40 detectors, 20 smart switches)

### 3. High Level of Security

Hidden tamper switch to prevent malicious damage

Built-in 1,000,000 RF codes

105-dB siren deterrence

### 4. User-friendliness

Addition and removal of accessories by category

App remote control alarm system and home appliance switch control

## Packaging List

Please check if the following items are contained in the package. In case of any missing parts, please contact the distributor/retailer.

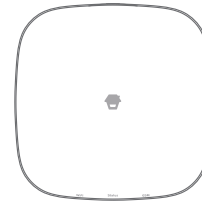

H4 Panel ×1

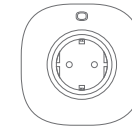

H4-PW Smart switch ×1



RC-80 Remote control x  
2



PIR-910 PIR Motion Detector  
x 1

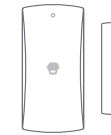

DWC-102 Door/window  
contact x 1

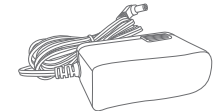

AC adapter ×1



H4 Stand ×1



PIR stand ×1



Double-sided tap for  
door/window contact x 2



User manual ×1

# Operating Principle

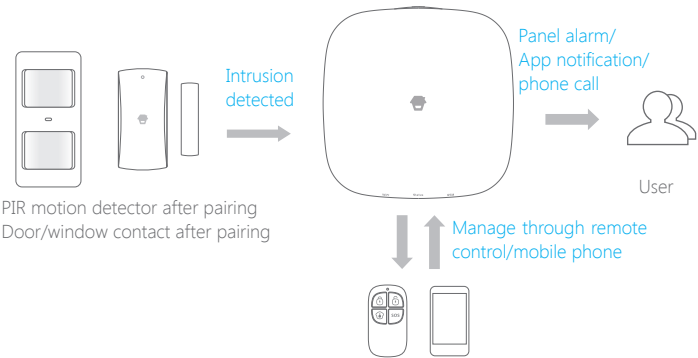

Operating Principle of security system

## Categories of Detector Zones

**Normal Zone:** If panel is set to Arm or Home arm, normal zone detector will enter operating mode. Any detection of intruders or an emergency situation will trigger the panel alarm.

**Home Zone:** If panel is set to Arm, home zone detector will enter operating mode. Any detection of intruders will trigger the panel alarm. If panel is set to Home Arm, no alarm signal sent from the home zone detector will be processed.

**Delay Zone:** This is the alarm delay zone. If panel is set to Arm, delay zone detector will turn the alarm on after the designated period of time once triggered. This usually applies to the door/window contact of the entrance door. For example, if door/window contact of entrance door is set as delay zone and the delay time is 30 seconds, the user will be reminded with a warning sound from the panel to set the system to Disarm mode after entering the home under the Arm condition. If panel has not been set to Disarm after 30 seconds, it will sound the alarm.

**24-Hour Zone:** 24-hour zone operates independently of the setting of Arm or Disarm. Once the zone is triggered, the alarm will be immediately activated.

Categories	Factory Default Zone
PIR-910 PIR Motion Detectorr	Home Zone (Modifiable via App)
DWC-102 Door/Window Contact	Normal Zone (Modifiable via App)

# Operating with Multiple Smart Switches

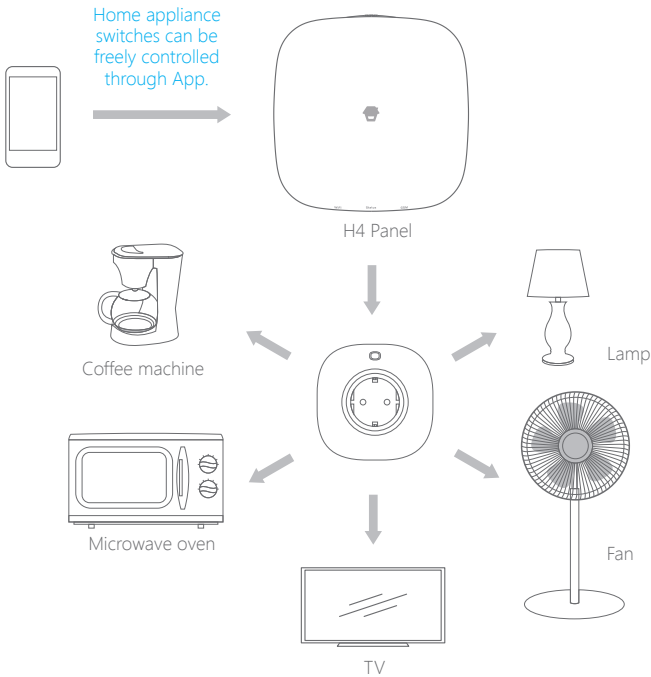

Operating Principle of Home Appliance Control

## Introduction of Panel

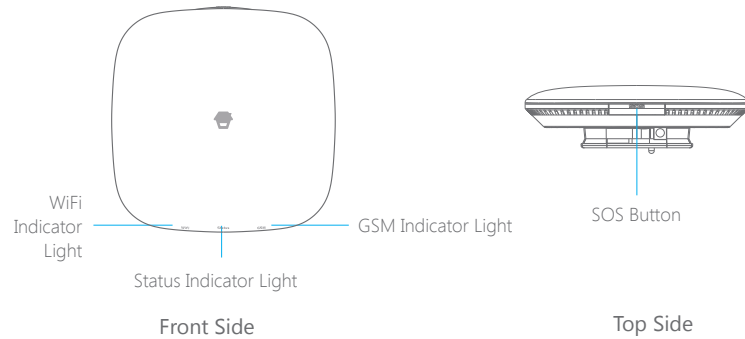

### Description of Indicator Light

Indicator Light	Status	Meaning
WiFi Indicator Light	Flash slowly (once every 3 seconds)	WiFi network searching
	Flash quickly (once every second)	Configuration status
	Steady on	WiFi network connected
Status Indicator Light	Blue light is steady on	Home arm
	Green light is steady on	Disarm
	Red light is steady on	Arm
	Flashing	Panel alarm
	Red, green and blue lights flash simultaneously	Panel is in low battery condition. Please connect with AC power.
	Off	Panel is not powered on, or not powered with adapter
GSM Indicator Light	Flash quickly (once every second)	Searching the GPRS network
	Flash slowly (once every 3 seconds)	GPRS network connected
	Off	No SIM card

**Note:** After pressing the SOS button, the panel will immediately sound the alarm.

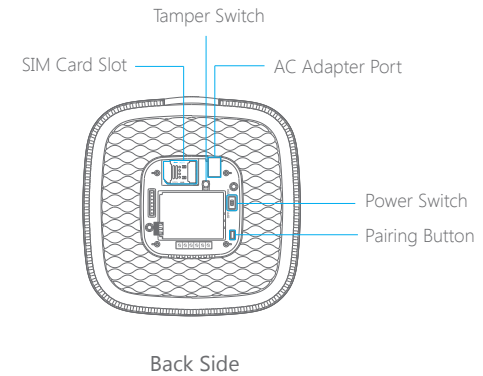

**Note:** After pressing the Tamper Switch, the panel will immediately sound the alarm.

### Powering on the Panel

Connect AC adapter to power outlet → When the power is OFF, insert your own SIM card → Turn power switch from OFF to ON → When GSM indicator light flashes slowly (once every three seconds), GPRS network has been connected.

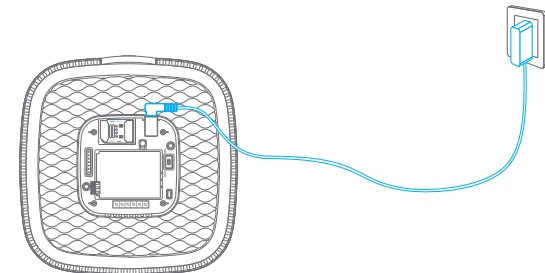

**Note:** The SIM card should allow you to make and receive calls, with function of GPRS, SMS and caller ID activated. If the user only chooses WiFi control system, insertion of SIM card is not required. Then there will be push messages sent from the APP instead of alarm phone calls upon sounding of alarm.

## Positioning of Panel

Place on the table. For best reception of the wireless signal, it is recommended that you place the panel in an open area that is located centrally to the whole alarm system. Avoid placing the panel on a load-bearing wall or beside any electrical appliances.

### Set on the Table

After closing the back cover of the panel and tightening the screws, it can be placed on the table for use.

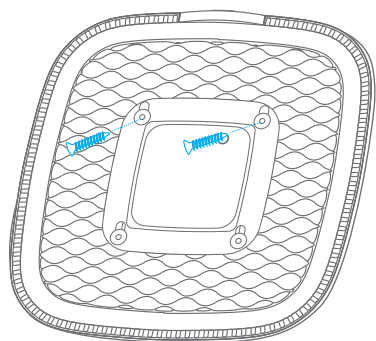

## Use of Accessories

### Remote Control

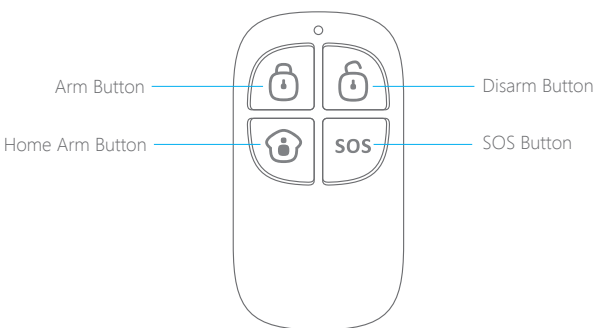

### Description of Indicator Light

Buttons	Status
	Press Arm button and the panel will make a "Di" sound once, setting the system to Arm.
	Press Disarm button and the panel will make a "Di" sound twice, setting the system to Disarm.
	Press Home Arm button and the panel will make a "Di" sound once, setting the system to Home Arm. Under this condition, home zone accessories will be set to Disarm to enable home activities of the owner.
<b>SOS</b>	Press SOS button, the indicator light goes on. The panel will immediately sound the alarm.

**Note:** If, upon pressing a button, the LED light flickers twice and then goes out, then the remote control battery is low. Please replace the battery as soon as possible.

## Door/Window Contact

Door/window contact is for detection of the opening-closing state. If the system is set to Arm and the transmitter is more than 2cm apart from the magnet, the panel will receive an alarm signal from door/window contact and then sound the alarm.

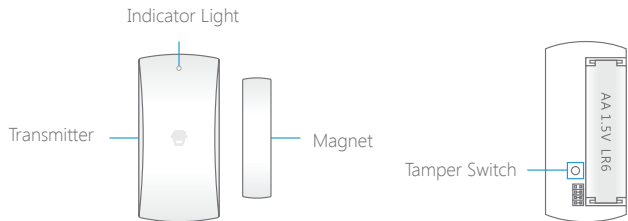

**Note:** Indicator light flashes once: Door/window contact is triggered.  
Flashes once after 2 seconds when triggered: The battery is running low. Please replace the battery as soon as possible.  
After pressing the Tamper Switch, the system will immediately sound the alarm.

## Important!

Door/window Status Alert: When arm/ home arm the system without door/window closed, the panel will sound "DiDi" to remind you for 15s. If press the Arm button again, the sound will stop and system arm immediately.

## PIR Motion Detector

PIR motion detector adopts digital dual-core fuzzy logic control processing technology and an intelligent analysis algorithm. Upon detection of human body movement, the panel will receive an alarm signal and then sound the alarm.

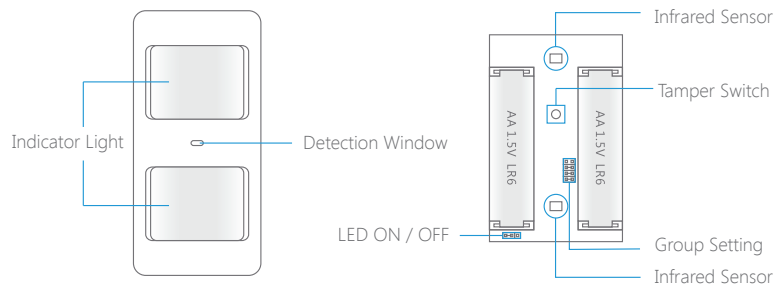

**Note:** Indicator light flashes once: Motion is detected.  
Flashes three times per second: The battery is running low. Please replace the battery as soon as possible.

## Working Mode

### Testing Mode

After removing the insulating strip, the PIR motion detector will conduct a self-inspection for around 1 minute and then enter testing mode. The detector carries out detection every 10 seconds. After 3 minutes, the status indicator blinks twice, and the detector switches to power saving mode.

**Note:** Equipped with the batteries with pressing and holding the test button, the motion detector will remain in the testing mode eternally. That is detecting every 10 seconds. Reloading the batteries can exit this mode.

### Power Saving Mode (Default Setting)

This product is designed with an intelligent power-saving mode. If human body movements are detected twice within 3 minutes, it will be automatically switched to sleeping mode to save power. Any movement within the detection zone will not turn the light on or send an alarm signal. If no human body movements have been detected after 3 minutes, the PIR motion detector automatically returns to the alert mode.

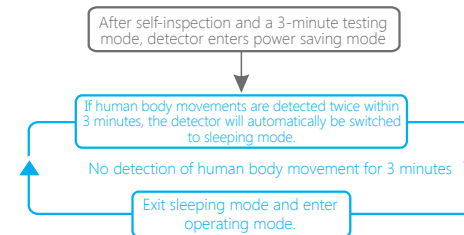

## Detection Area

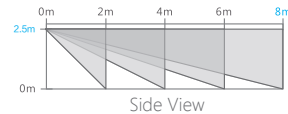
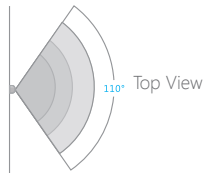

## Smart Switch

The H4 panel can be matched with multiple smart switches. You can control home appliances remotely using these switches.

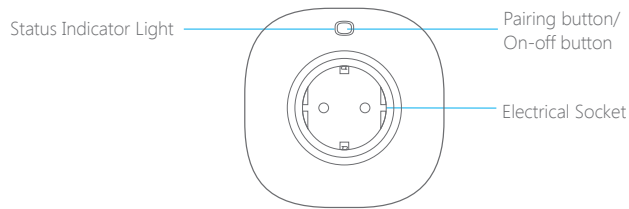

**Note:** When the power is on, the status indicator light will glow steadily; when power is off, the status indicator light will turn off.

## Accessory Pairing/Removal

Accessories in this kit was paired before the products left the factory. New accessories have to be paired with the panel successfully before installation for use.

### Pairing Wireless Accessories

Press the Pairing button once on the panel (see fig.). The panel will make a “Di” sound once, before entering pairing mode. If you trigger the wireless accessory once, the panel will make a “Di” sound once; this completes pairing with the panel. Names of the detectors can be customized via App.

**Note:** If the panel makes a “Di” sound once, that means successful pairing; if the panel makes a “Di” sound twice, that means repeated pairing.

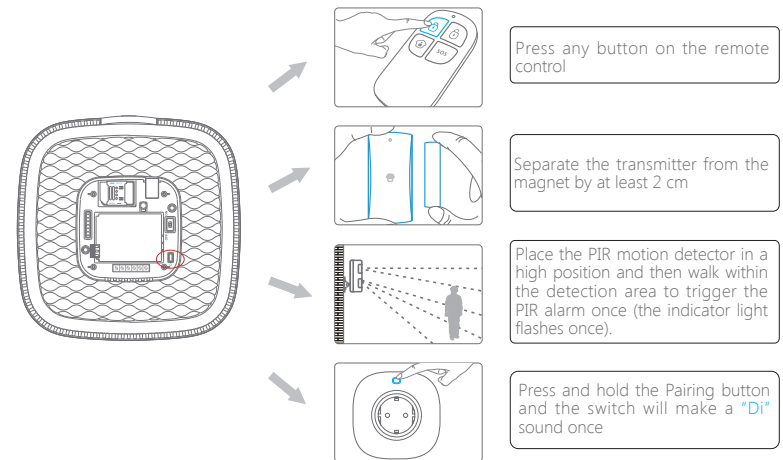

### Pairing Wireless Siren (requires separate purchase)

Press the Pairing button of the wireless siren once; it will make a “Di” sound once, before entering pairing mode. Then press the Pairing button of the panel twice; the wireless siren will make a “Di” sound once, that means repeated pairing.

### Removal of Wireless Accessories

Press and hold the Pairing button of the panel for 5 seconds until it makes a “Di” sound once and then release. All wireless accessories have been removed. Wireless accessories can also be removed by category through the App.

### Removal of Wireless Siren (Requires Separate Purchase)

Press the Pairing button of the alarm for 8 seconds and it will make a “Di” sound once, successfully disconnecting the wireless siren from the panel.



## Installation of Accessories

Upon confirmation of successful pairing, enter installation processes.

### Installation of Door/Window Contact

#### Step 1: Choose a Suitable Place

The contact can be mounted on objects that can be opened/closed like doors, windows, and cabinets. To mount on a metal door, please block up the contact.

#### Step 2: Use Double-sided Adhesive Tape on the Back of Door/Window Contact

When attaching the contact, ensure the distance between the transmitter and the magnet is less than 1 cm. When the distance exceeds 2 cm and the transmitter flashes, this means the door/window contact is functioning properly.

#### Step 3: Testing

Set the panel to arm and then trigger the door/window contact (open the door or window) to ensure proper functioning of the panel in receiving signals from the accessory.

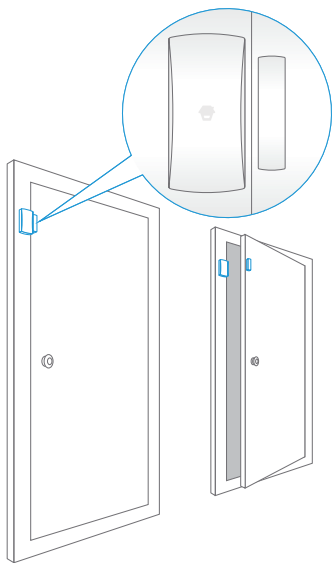

### Installation of PIR Motion Detector

**Installation notice:** Should not face glass doors/windows; should not face objects that easily swing; should not face any source of cold or heat, such as a heater, air-conditioner, refrigerator or microwave oven; avoid installing two PIR motion detectors within the same detection area to prevent mutual interference.

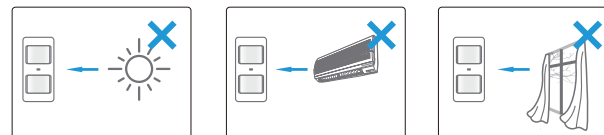

#### Step 1: Choose a Suitable Place

For best detection, it is recommended that you use a piece of 3M double-sided adhesive tape inside the package to mount the PIR motion detector on a clean wall at the corner of a major passageway (e.g. living room and corridor) at 2.2-2.5 m above the ground.

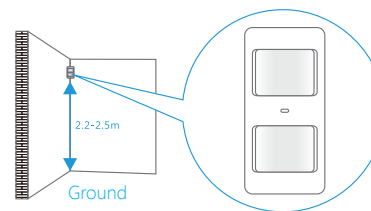

#### Step Two: Test the PIR Motion Detector

After mounting the detector, move within the detection area and observe the status indicator light. If any human body movement is detected, the status indicator light will flash once.

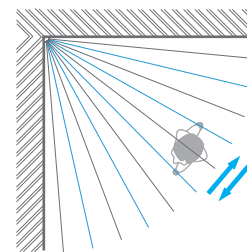

**Note:** You may also use an accessory stand and screws to mount the product in a special position and then achieve best detection through the walking test and manual adjustment of angles.

#### Step 3: Testing

Set the panel to Arm and then trigger the detector to ensure proper functioning of the panel in receiving signals from the accessory.

## App Setting and Operation

H4 has WiFi and GPRS dual-network function. During the use of WiFi, the GPRS network will be disconnected. If the WiFi connection fails (e.g. the Internet connection is unstable or there is no power supply from the adapter), it will be automatically disconnected and the search for the GPRS network will begin.

### Step 1: Download App

iPhone Mobile: Enter App Store, type the search keyword "H4 Smarthome" and then download for installation. Android Mobile: Enter Google Play mobile app store, type the search keyword "H4 Smarthome" and then download for installation.



### Step 2: WiFi Network Setting

1. Press the pairing button of the panel three times. The panel will make a "Di" sound once and the WiFi indicator light will flash quickly (once per second), means it enters network configuration mode.
2. Open App, tap [\[Network Configuration\]](#) and then follow the instruction in the app. When the WiFi indicator light is steady on means wifi network connected.

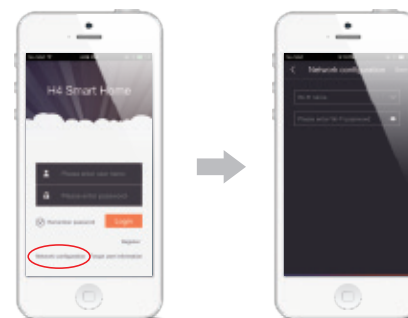

**Note:** In case of any change of the router name or password, please set up the network configuration again. User may choose GPRS network control system without configuration of WiFi network. After insertion of a SIM card and a slow flash (once every three seconds) of the GSM indicator light, you can proceed with registration and log on the App and then start to use it.

### Step 3: Registration

Enter the user name, password, panel ID No. and SN code in the registration interface to complete registration.

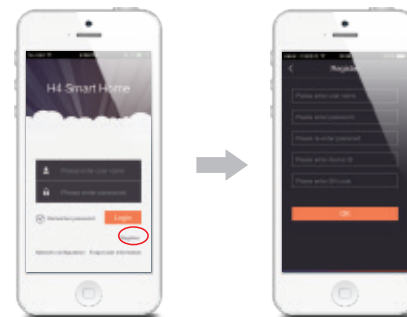

**Note:** Each panel has its own ID and SN code shown at the bottom of the panel. Please keep it properly. You may tap [\[Forgot User Information\]](#) to retrieve a forgotten username or password.

## Step 4: App Operation

### Alarm Control

All paired accessories are shown in the alarm control interface. A bright image indicates Arm status of the detector, while a dark image indicates that the detector is set to Disarm. User may set the system to Arm, Disarm, or Home Arm. Tap the detector icon and enter the interface for accessory configuration to customize the image, name and zone category of accessories.



### Smart Switch

All paired smart switches are shown in this interface. A bright image indicates that the smart switch is on, while a dark image indicates that the smart switch is off. Tap any of the smart switch images to enter the configuration interface for that switch. You may switch it on/off, select image, rename and set time switch, etc.

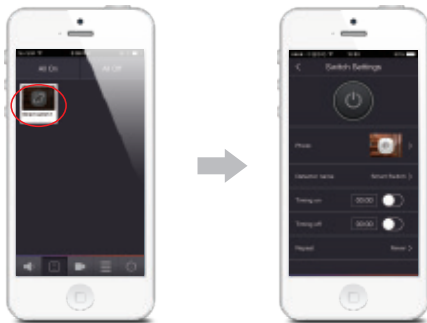

### Rule Settings

Rule settings refer to activating the whole set of smart switch modes according to different scenarios. When the panel is set to Arm, Disarm, Home Arm, or Alarm, the switches with preset rules will automatically turn on/off accordingly. Switches without preset rules will remain unchanged.

### Scenario for Arming

Tap [If Panel is Set to Arm] and then choose whether to activate the rule in the interface of rule settings. Under this rule, select the smart switch to be connected and its status. Tap [Save]. If panel is set to Arm thereafter, the smart switch selected will be turned on/off according to the status of this scenario setting. There is also Disarm scenario mode, Home Arm scenario mode, Alarm scenario mode, and so on.

E.g. when panel is set to Arm, turn the table lamp off.

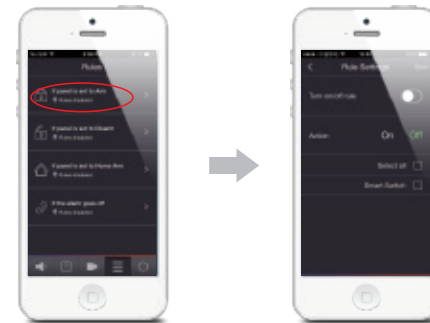



**Note:** If you want to cancel the scenario mode, just turn off this rule.



## System Settings

Tap  and enter the interface for system settings to perform operations.

### Account Management

Enter the interface for account management and tap [\[+\]](#). You may add subuser accounts; enter usernames and tap [\[Confirm\]](#). The account labelled with  is the master account. Tap the  button to change the password for this account. The master may add a maximum of 5 subuser accounts in this interface.



**Note:** The default subuser password is 123456. To change the password, login to the App by entering the subuser account name and the default password, and then tap the  button in the interface for user management. To remove a subuser account, tap App . After cancellation of the account, subuser accounts added by that user will also be cancelled.

### Save Alarm Phone Number

With a SIM card inserted into the panel, you may switch to the GPRS network to remote control the system during disconnection of WiFi network. After saving the alarm phone number in the App interface below, the user will receive an alarm call in case of emergency.



### Internal Siren Setup

1. The arm/disarm tone of the internal siren can be turned off by slipping the switch on the App.
2. Tap [\[Internal siren volume\]](#) to choose the alarm volume level: mute, low, medium and high. The default setting is high.
3. Tap [\[Internal Siren Ringing Time\]](#) to set internal siren alarming duration from 1 to 9 minutes. Default setting is 5 mins.

### Entry & Exit Delay

If you do not want to carry the remote control, you may set a system delay time. Delay refers to entry & exit delay, including Arm delay before leaving home and Alarm delay after entering the home. If the delay time is set to 30 seconds, set the system to Arm before leaving home. The panel will make a "Di" sound once every 2 seconds to remind the user to leave. The warning tone will speed up during the last 15 seconds. From setting the system to Arm to the start of operation, 30 seconds will elapse. A system that has been set to Arm status will activate the alarm 30 seconds after a user triggers an accessory ( which sets to entrance delay zone ) upon entering the home, thereby giving the user enough time to set the system to Disarm.



### Ringtone of Push Alert

When system goes alarm, it will push an alert to user's smart phone with the default ringtone. There are 5 distinguishing ringtones available for choosing to avoid missing the alert.



### Add Accessories

Accessories can also be paired in App. After tapping [\[Add accessory\]](#) in the setting interface, please follow the guidance on the interface.

### History

Tap [\[History\]](#), the latest 100 records of alarm and operation information can be traced.

### Panel Tamper Switch

After this function is enabled, whenever this Panel Tamper Switch (a tall white button underneath the back cover) is released, it will activate an alarm to indicate an unauthorized attempt is made to remove the Panel from its installed location.

Default setting: Off

## APN Setting

If the system is controlled through GPRS data, some SIM cards may be required to set APN first to enable the GPRS function. so if the GPRS function of the SIM card in H4 doesn't work. Do as follow:

1. Make sure the control panel not connect with WiFi before this APN setup or you can power up the control panel only by battery.
2. Send 'APN' to the SIM card in the control panel; you'll get a message back. Forward and fill in related APN, username and password, then send it back. You'll get a message 'Operation Succeeded' from the SIM card in the control panel, after a while, the GSM indicator on control panel will blinks every 3 seconds to notify you that the GPRS connection is successful, then you can operate the APP via GPRS freely. For instance, for SIM card from Vodafone in Netherlands, there is no username and password, leave it as it is. A message replied 'OK', means the setup is successful.

APN

APN:  
User name:  
Password:

APN:live.vodafone.com  
User name:  
Password:

Operation succeeded

**Note:** The APN setting varies in different countries. Consult the local operator on how to set the APN correctly.

## Remote Control by Phone

1. The authorized phone number (those you saved on App) can dial the SIM card No. of the panel to remotely control the system. After getting through, the system will immediately enter the monitoring state. Users may also control the system remotely by typing the corresponding numbers (see list below) on the mobile phone keypad. Commands from unauthorized phone number will be rejected.
2. When the panel is alarming, it will dial the saved alarm phone numbers. After getting through, the user may control the system remotely by typing numbers on the mobile phone keypad.

### Remote Control Command List:

Buttons	Function Settings
0	Disarm
1	Arm
6	Turn off siren alarm
9	Turn on siren alarm
*	Two-way intercom
#	Hang up

**Note:** Once you have accessed the system remotely, the panel will automatically end the phone call after 30 seconds of non-operation.

## Restore Default Settings

Restoring the default settings means restoring the system to its initial status. Press the [\[Tamper Switch\]](#) button (see page 6) on the control panel 5 times consecutively; the panel will then make a “Di” sound once, successfully restoring the default settings (including network configuration).

**Note:** Accessories that have been paired with the panel are still effective for use. There is no need to perform pairing again.

## FAQs

If the alarm system does not function properly, please read the following FAQs and carry out troubleshooting before contacting the Chuango service center. During troubleshooting, please ensure that the panel power is on: switch it from OFF to ON.

Problems	Causes/Solutions
Unable to turn on the panel	Ensure proper connection of the power line
	Ensure the power adapter is transmitting electricity
Insertion of SIM card into the panel shows no response	Confirm that it is a GSM SIM card
	Ensure the SIM card is inserted in the correct direction
	Confirm that the card has been inserted before switching on the panel
	Confirm that the SIM card can display incoming calls and SMS, and that it has the GPRS function, without any special service constraints
App fails to connect to network/“The device is offline”	Check if the local network operates properly
	Need to configure network on the App
Remote control shows no response	Ensure successful pairing between the remote control and the panel
	Ensure appropriate wireless distance from the panel: <80 m (open area)
Door/window contact does not sound the alarm	Confirm that the panel is set to Arm or Home Arm
	Ensure proper positioning of the magnet
	Ensure appropriate distance between the door/window contact and the panel: <80 m (open area)
	Confirm that the transmitter flashes when apart from the door/window contact
PIR motion detector does not sound the alarm	Confirm that the panel is set to Arm
	Ensure successful pairing between the panel and the PIR motion detector
	Ensure appropriate distance from the panel: <80 m (open area)
	Upon confirmation of the above, if the PIR motion detector still does not flash or activate the alarm, it may enter sleeping mode when somebody passes by, learn more about specific requirements for its operation and installation positions.
Smart switches show no response when controlled by the App	Ensure successful pairing between the smart switches and the panel
	Ensure appropriate distance from the panel: <80 m (open area)

No phone call notification upon sounding of alarm	Confirm that the SIM card is not in arrears
	Confirm that the alarm number has been set
	If you set the system to Disarm immediately after the sounding of the alarm, there will be no phone call notification
No sound emitted from the alarm	Check if the panel is in mute mode. You can adjust the volume through the App
Unsuccessful pairing between the wireless accessory and the alarm panel	Confirm that the operating frequency of the wireless accessory is the same as that of the alarm panel
How long does the remote control battery normally last?	A CR2025 button battery usually lasts about 1 year.
How long does the door/window contact battery normally last?	One piece of 1.5V AA LR6 battery, lasts for about 1 year.
How long does the PIR motion detector battery normally last?	Two pieces of 1.5V AA LR6 battery, lasts for about 1 year.

## Specification

### Panel

Model	H4
Power Supply	DC 12V 500mA
Built-in Battery	3.7 V 800 mAh Lithium Battery (BL-5B)
GSM Operating Frequency	850/900/1800/1900 MHz
WiFi	IEEE 802.11b/g/n
Standby Current	<100 mA
Alarm Current	<300 mA
Internal Siren Volume	105 dB
Max. No. of Connectable Wireless Accessories	10 Remote Controls, 40 Detectors, 20 Smart Switches
Wireless Radio Frequency	315MHz or 433MHz
Casing Materials	ABS Plastics
Operating Conditions	Temperature: 0°C ~ +55°C Relative Humidity<80% (No Condensation)
Size of Alarm Panel (L x W x H)	160 x 160 x 45 mm
Size of Stand (L x W x H)	80 x 80 x 10 mm

### RC-80 Wireless Remote Control

Power Supply	DC 3V (CR2025 Lithium Battery x 1pc)
Alarm Current	< 7mA
Transmitting Distance	< 80m (in open area)
Radio Frequency	315MHz or 433MHz
Housing Material	ABS plastic
Operating Condition	Temperature 0°C ~+ 55°C Relative Humidity < 80% (non-condensing)
Dimensions (L x W x H)	58 x 31 x 9.5mm Relative Humidity<80% (No Condensation)
Size of Remote Control (L x W x H)	58 x 31 x 9.5 mm

### DWC-102 Wireless Door/Window Contact

Power Supply	DC 1.5V (AA 1.5V LR6 Battery x 1 pc)
Static Current	< 35uA
Alarm Current	< 40mA
Transmitting Distance	< 80m (in open area)
Radio Frequency	315MHz or 433MHz
Housing Material	ABS plastic
Operating temperature	Temperature 0°C ~+ 55°C Relative Humidity < 80% (non-condensing)
Transmitter Dimensions (L x W x H)	71 x 34 x 17.5mm
Magnet Dimensions (L x W x H)	51 x 12 x 13.5mm
Size of Magnet (L x W x H)	63 x 19 x 13 mm

### PIR-910 Pet-Immune PIR Motion Detector

Power Supply	DC 3V (AA 1.5V LR6 Battery x 2 pcs)
Static Current	< 18uA
Alarm Current	< 12mA
Detection Scope	8m/110°
Pet Immunity	< 25kgs
Transmitting Distance	< 80m (in open area)
Radio Frequency	315MHz or 433MHz
Housing Material	ABS plastic
Operating Condition	Temperature 0°C ~+ 55°C Relative Humidity < 80% (non-condensing)
Detector Dimensions (L x W x H)	108 x 52 x 36.8mm
Bracket Dimensions (L x W x H)	52 x 30 x 26.5mm

### Smart Switch

Model	H4-PW
AC Input/Input Range	AC 100 ~ 240 V, 50/60 Hz
Maximum Load Operating Current	<10 A
Operating Current	<24mA ~ 70mA
Maximum Power	2500 W
Wireless Distance	<80m (Open Area without Interference)
Casing Materials	PC+ABS Plastics
Operating Conditions	Operating Temperature: 0°C ~ +55°C Storage Temperature: 0°C ~ +70°C Relative Humidity<80% (No Condensation)
Size of Smart Switch (L x W x H)	90 x 90 x 37 mm (excl. plug)



## Safety Reminder

---

Please read the following rules. Any non-compliance may cause damage to the equipment or affect its performance.

1. Reasonable use  
Please read this manual in detail before use and operate the device(s) according to the specifications.
2. Please do not allow any liquids or foreign objects to get into the equipment.  
The alarm system is not waterproof. Please keep it dry. In case any liquids or foreign objects get into the equipment, you should immediately turn it off and take the battery out.
3. Choose qualified repair services  
Do not try to disassemble or repair any part of the equipment except as stated in this manual. Only professional maintenance personnel may repair the equipment.
4. Use original accessories  
You can only use original accessories recognized by our company. We shall not accept liability for any damage/accidents (e.g. fire) caused by malfunctions of non-Chuango accessories (e.g. battery leakage/explosion).
5. Avoid use or storage in the following conditions  
Avoid use or storage in intense direct sunlight, at a temperature higher than 55°C, or in a humid or dusty environment in order to prevent fire, burn injuries or other damage induced by battery leakage, overheating or explosion. High temperature may also cause deformation of the casing.

## Maintenance and Repair

---

The alarm system is produced with superior design and craftsmanship. Please use it carefully. The following advice will facilitate your adherence to the conditions stated in the warranty clauses and prolong product life.

1. Please keep out of reach of children.
2. Please keep the alarm system dry. Rainwater, moisture and other kinds of liquids may contain minerals that can corrode the electronic circuits.
3. Please do not place or use the alarm system in a dusty or dirty environment, in order to prevent any damage being caused to its electronic components.
4. Keep the alarm system out of areas with extreme heat. High temperature will shorten the useful life of electronic equipment, damage batteries, as well as cause melting and deformation of some plastic components.
5. Avoid placing the alarm system in an environment with extreme cold, or else when room temperature is restored, internal components of the alarm system may become humid, destroying the circuit board.
6. Please perform regular tests on the alarm system. If any problem is found, address it as soon as possible.
7. Please regularly check the condition of the built-in battery of each wireless accessory. If a battery is running low, please replace it as soon as possible to prevent any interference with normal use.
8. Since the alarm system is charged with electricity or on standby mode for prolonged periods of time, please connect the panel power adapter to a safe and reliable power socket.
9. Please do not place the panel or the external alarm in a bedroom or beside an office table, in order to prevent disturbance of your sleeping or working time due to the sound emitted during the sounding of the alarm.
10. If the alarm system is not going to be used for a prolonged period of time, please disconnect the power supply.
11. If there is dust on the surface of the alarm system, please wipe it with a piece of soft cloth or tissue; in case of dirt, please soak a piece of soft cloth in diluted alkaline detergent and then wring it out before wiping. Then use a dry, absorbent cloth to wipe the surface dry.

Please carefully read the above advice and operate the device(s) according to the specifications. If the equipment does not function properly, please bring it to the purchase location or an authorized repair location for maintenance. We will help fix it as soon as possible.

## Disclaimer

---

We have striven to provide accurate and complete information during the preparation of this manual, but we do not guarantee that this manual contains no inaccurate or missing parts.

Chuango reserves the right to amend the specifications of the hardware and software mentioned in this manual at any time without prior announcement.

Without the prior written authorization of Chuango, you shall not copy, transfer or record any part of this manual, save it in any searchable system, or translate it into any language.

Chuango shall not accept liability for maloperations or malfunctions of the panel or accessories, nor for damage caused by data corruption or data loss attributable to the use of non-Chuango products.